



LOUISIANA NATURAL AND SCENIC RIVERS SYSTEM

# PERMIT APPLICATION

Permit # 1424 (Assigned by Department)

The Louisiana Department of Wildlife and Fisheries' Scenic Rivers program is authorized by LRS title 56, Chapter 8 Part II. This law requires permits authorizing activities in or affecting rivers that have been designated by the Louisiana Legislature as Natural and Scenic. Information provided on this form will be used in evaluating the application for a permit. Information in this application is made a matter of public record through issuance of a public notice. Disclosure of the information requested is voluntary, however, the data requested necessary in order to communicate with the applicant and to evaluate the permit application. If necessary information is not provided, the permit application cannot be processed nor can a permit be issued.

## APPLICANT INFORMATION

Name of Applicant <b>Roy A. Comardelle</b>	Name of Agent (if any)
Address <b>186 W. Bayou Rd</b>	Address
City, State, Zip <b>Des Allemands, LA 70030</b>	City, State, Zip
Phone <b>504-952-0329 or 504-952-0330</b>	Phone
Email Address <b>Adaline.Comardelle@gmail.com</b>	Email Address

## DESCRIPTION OF THE PROPOSED ACTIVITY

Brief summary of the description and purpose of the proposed activity (details to be attached as a separate document)

**Requesting a permit for a dock on scenic waterway Bayou Des Allemands (details attached)**

Is any portion of the activity complete?  YES or NO (If yes, indicate month and year of completion) **07/01/2025**

## LOCATION OF PROPOSED ACTIVITY

Stream Name	<b>W. Bayou Rd</b>
Address	<b>186</b>
City, State, Zip	<b>Des Allemands, LA 70030</b>
Parish	<b>Lafourche Parish</b>
Sec/Township/Range	<b>Des Allemands</b>
Latitude/Longitude	<b>29° 49' 14.60"N 90°28'41.57"W</b>

## ADJACENT LANDOWNERS

Names, Addresses, Phone Numbers of Adjacent Landowners
<b>Doyle Cornwell</b>
<b>Ray Pickett</b>
<b>Bryan Champagne</b>

## ENVIRONMENTAL ASSESSMENT

Must be a separate document. See the attached instruction sheet for completing the assessment.

## CONFIRMATION OF INFORMATION ACCURACY

Application is hereby made for a Scenic River Permit to authorize the activities described herein. I certify that I am familiar with the information contained in this application and that, to the best of my knowledge and belief, such information is true, complete, and accurate. I further certify that I possess the authority to undertake the proposed activities, or I am acting as the duly authorized agent of the applicant.

*Roy Comardelle*  
Signature

**04/15/2026**

Date

JEFF LANDRY  
GOVERNOR



TYLER M. BOSWORTH  
SECRETARY

PO BOX 98000 | BATON ROUGE LA | 70898

Dear Scenic River Permit Applicant:

Please review and concur on the following statement regarding the issuance of permits by the Louisiana Department of Wildlife and Fisheries. This agreement must be signed and returned before a Scenic River Permit can be issued.

"I have been advised and do understand that by applying for and accepting a Scenic Rivers permit issued by the Louisiana Department of Wildlife and Fisheries, I am being allowed to engage in an activity which would otherwise be prohibited by law or for which a permit is required. I understand that the permit is not a license and confers no property right upon me. I specifically agree to abide by all State and Federal fish and wildlife laws and regulations, and all State and Federal laws and regulations which relate to this permit or the permitted activity, and by all other terms and conditions of this permit. I understand that the permit for which I am applying may be suspended, annulled, withdrawn or revoked and that I may be assessed civil penalties, all in accordance with the provision of the Louisiana Administrative Procedure Act, and that I may be denied future permits as a consequence of my failure to fully and completely comply with the terms and conditions of the permit, as well as other laws and regulations pertinent thereto. If served with or notified of a cease and desist order signed by the Scenic Rivers Administrator, I agree to immediately and without delay cease all activities and operations which relate to the permitted activity or which are impacting the Scenic River, until such time as the matter can be resolved in an adjudicatory hearing pursuant to the Louisiana Administrative Procedure Act. I understand and agree that any permit issued to me by the Louisiana Department of Wildlife and Fisheries is in the nature of a privilege which is being voluntarily extended to me by the Department and the failure on my part to cooperate with the Department can result in the loss of the privilege conferred and the denial of future requests for permits. By accepting this permit, I evidence my agreement to be bound by all conditions and stipulations set forth herein."

*Roy Conzelle*

Authorized Signature

04/15/2026

Date

REV. 5/23/25

## Scenic Rivers – Environmental Assessment

Project Description: Proposal to Replaced previous dock due to the structure age and condition and safety of the old dock at 186 W Bayou Rd. on Bayou Des Allemands

1. Existing Land Use

The land is owned by Roy A. Comardelle Sr. and used for docking boats, and leisure activities. The previous property was a crab factory used for over 50+ years by local crab fisherman. The factory was aging and conditions were causing a safety hazard for boaters and the community on W. Bayou Rd.

2. Wilderness Qualities

The project will have no negative impact on wilderness qualities. The area is next to the bulkhead on the West side of Bayou Des Allemands. There is no negative impact on wildlife or the waterway as the dock is within the same area as the previous dock.

3. Scenic/Aesthetic Values

The scenic values will not be impacted by the proposed project. The project is similar to other piers, docks, and camps along the river. The dock will not impede the view of the scenic area. In fact, it enhances the look of the property and its scenic value.

4. Ecological Regimes

The proposed project should have no impact on the ecology of the river as the structures will not alter existing water flow patterns. Because the dock is above water, there will be no change to the bayou waterflow.

5. Recreational Use/Opportunities

The dock is a private dock used for docking boats. It will be used for recreational use for the private owner of the property such as fishing from the dock. The property is not for public use. It is private property for the owner at 186 W. Bayou Rd.

6. Fish and Other Aquatic Life

Fish and other aquatic life should not be impacted by the proposed project. Removal of the old concrete and replacement of the new pilons is temporarily disturbing the bottom, but all aquatic life does not disturb post placement of the new dock.

7. Wildlife

The wildlife on the property should not be permanently affected by construction activities. There is no clearing required. The waterway is already clear and does not require any additional clearing.

8. Historical and Archaeological Resources

To the best of our knowledge, no historical or archaeological resources of significance occur on the property.

9. Geological Resources

To the best of our knowledge, no geological resources adjacent to the river will be changed by the proposed project.

10. Botanical Resources

There are no plants or vegetation debris

11. Water Quality and Quantity

No change to water quantity or quality of the river is expected during or after construction. There will be no rock or concrete used for this project

12. Hydrologic Features

The proposed project will not have any significant impact on local hydrology.

13. Cultural Resources

There are no known cultural resources associated with this project.

14. Economic Impact of Project

If ever needed, the dock can be used by commercial fisherman to unload their catch if fishing in the local lakes and bayous.

**Steps to Minimize and/or Offset Potential Impacts to the River**

This dock gives the owner of W. Bayou Rd an opportunity to enjoy the scenic views and local lakes and bayous by boat and off the dock. This dock enhances the scenic views and does not obstruct the Bayou flow as the dock is raised above the waterline with nothing restricting the flow.

**Alternatives**

Any alternative construction methods or designs considered? The consideration for this dock was to ensure it replaces the old dock within the same location and with minimal support structures possible placed in the water to keep the waterway flowing freely and not disturb the aquatic life and wildlife.

**Applicant's Compliance History**

Have you been cited for any violation of the Scenic Rivers Act? Make this into a statement. (No violations sited. The request for permit was sent to me. This is the reason for this response.)

186 W. Bayou RD. Old Dock Google Satellite View



Old Dock Area  
Most of the dock fell in  
the water

# 186 W. Bayou Rd Dock Drawing

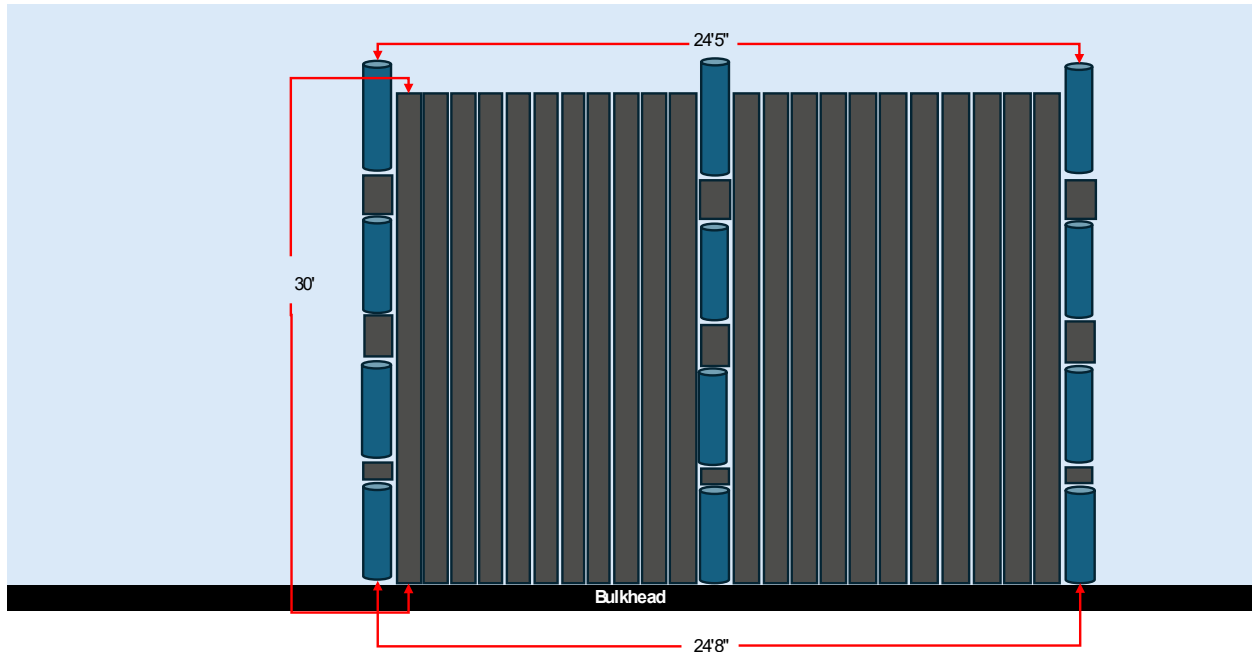

Legend	
Width Rd =	24' 8"
Width Water =	24' 5"
Length =	30'
Water Depth =	3' 6"
Water Depth Bayou =	6'
Water to top of deck <i>Fluctuates</i> =	3'
Height =	9'
Distance From Bulkhead =	1"

W. Bayou Road

Length 30'

1" from bulkhead

width 24'8"

width 24'5"

Bulkhead

9' Height

Water to Deck 3'

Water depth 6'

Water depth 3'6"

Bayou des Allemands

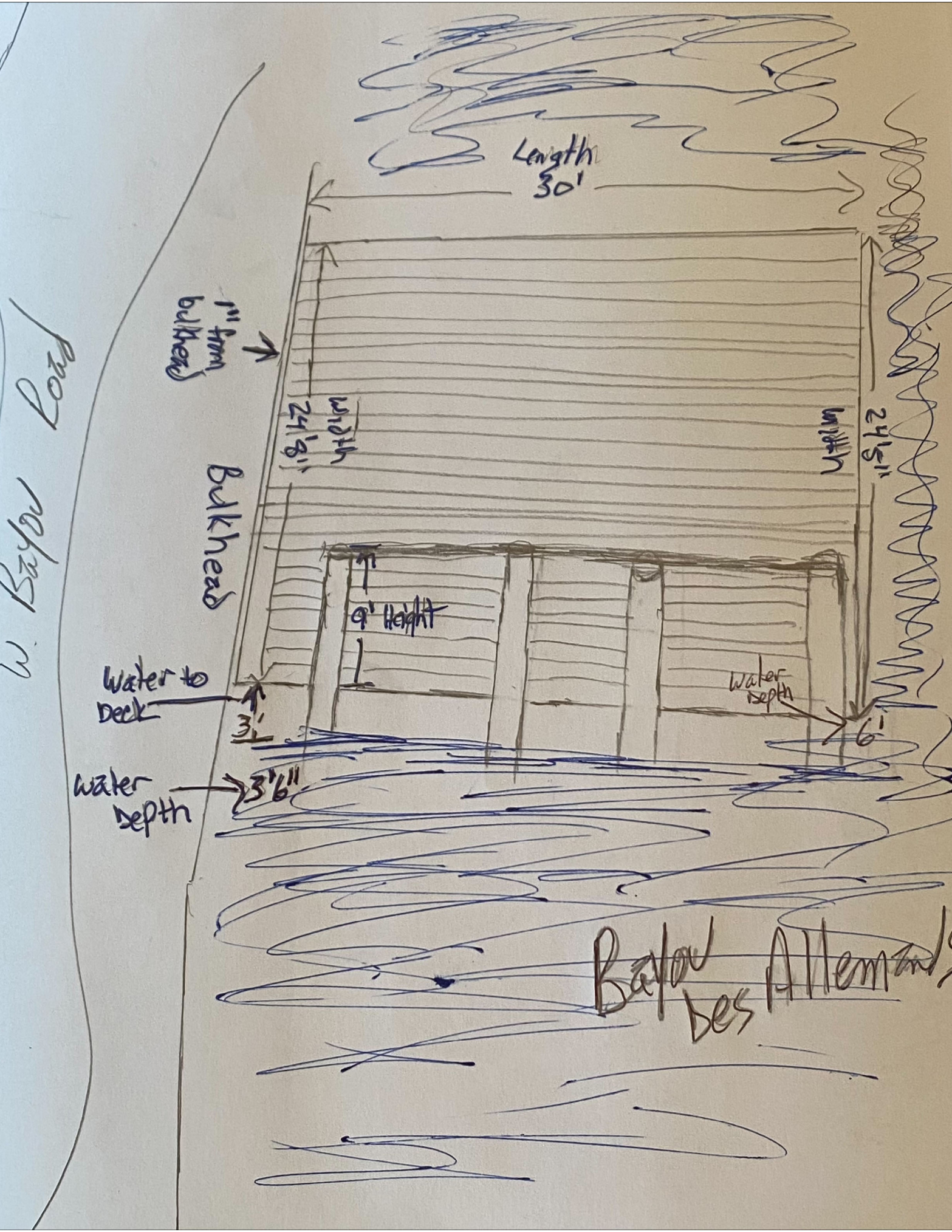

Google Satellite Old Dock zoomed in

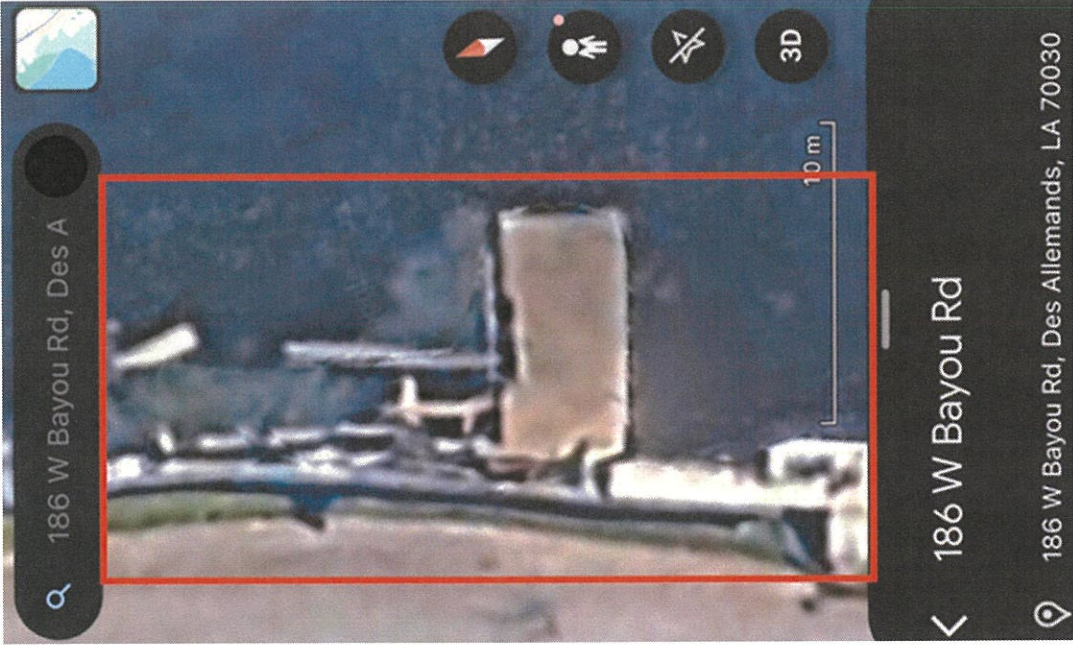

Google Satellite 186 W. Bayou Rd

29°49.56"N 90°28'41.60"W

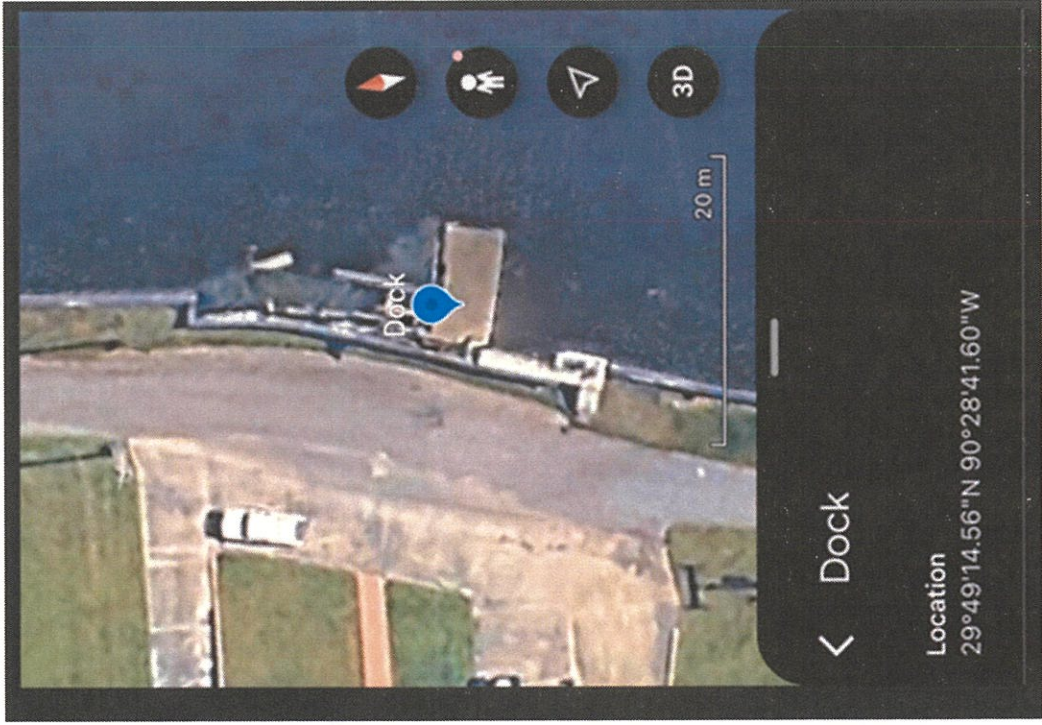

186 W. Bayou RD. New Dock

Looking South towards Mud lake



Looking East from the resident of 186 W. Bayou Rd.



Looking North towards the Des Allemands, LA Hwy 90 bridge

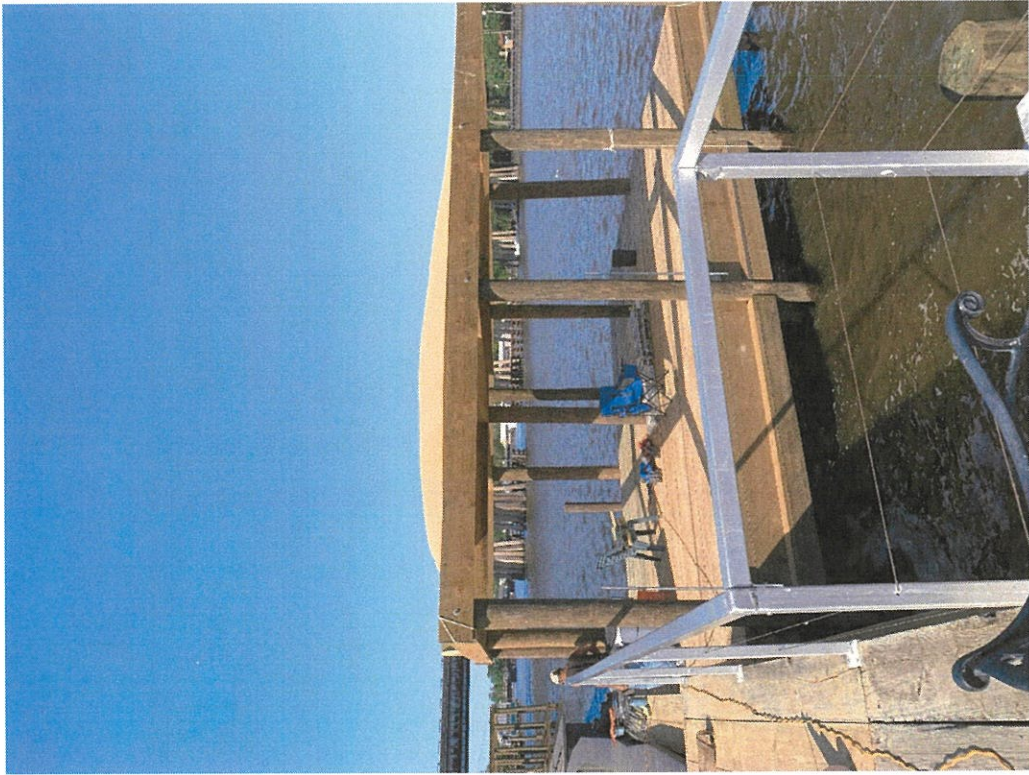

## Candies, Darid

---

**From:** Candies, Darid  
**Sent:** Wednesday, April 15, 2026 2:29 PM  
**To:** 'legal.ads@theadvocate.com'  
**Cc:** Adaline Comardelle; Darid Candies  
**Subject:** Louisiana Natural and Scenic Rivers Application Add

[@legal.ads@theadvocate.com](mailto:legal.ads@theadvocate.com),  
10705 Rieger Rd., Baton Rouge, LA 70809  
Phone: 225-388-0262 Fax: N/A  
Email: [legal.ads@theadvocate.com](mailto:legal.ads@theadvocate.com)  
Website: [theadvocate.com](http://theadvocate.com)

Can you please help me with running one issue in The Advocate (Baton Rouge).  
Request for Scenic River Permit on Bayou Des Allemands

The Secretary of the Louisiana Department of Wildlife and Fisheries (LDWF) as Administrator of the Louisiana Natural and Scenic Rivers System is currently considering the application of Roy A. Comardelle Sr. to build a dock. Copies of the application can be reviewed at the LDWF main office, 2000 Quail Drive, Baton Rouge, LA. The public is invited to comment on this permit request for a period of forty-five (45) days. Responses should be mailed to LDWF Scenic Rivers Program, P.O. Box 98000, Baton Rouge, LA 70898-9000.

Please inform all of the process to pay for this services and provide the proof of purchase and the add on the receipt.

Darid Candies  
704-612-1772

Adaline Comardelle  
504-952-0329

## Candies, Darid

---

**From:** Candies, Darid  
**Sent:** Wednesday, April 15, 2026 2:31 PM  
**To:** 'legals@dailycomet.com'  
**Subject:** Louisiana Natural and Scenic Rivers Application Add

[@legals@dailycomet.com](mailto:legals@dailycomet.com)

Daily Comet

P.O. Box 631825, Cincinnati, OH 45263-1825

Phone: 1-877-736-7612 Fax: N/A

Email: [legals@dailycomet.com](mailto:legals@dailycomet.com)

Website: [www.dailycomet.com](http://www.dailycomet.com)

Can you please help me with running three issues in The Daily Comet?  
Request for Scenic River Permit on Bayou Des Allemands

The Secretary of the Louisiana Department of Wildlife and Fisheries (LDWF) as Administrator of the Louisiana Natural and Scenic Rivers System is currently considering the application of Roy A. Comardelle Sr. to build a dock. Copies of the application can be reviewed at the LDWF main office, 2000 Quail Drive, Baton Rouge, LA. The public is invited to comment on this permit request for a period of forty-five (45) days. Responses should be mailed to LDWF Scenic Rivers Program, P.O. Box 98000, Baton Rouge, LA 70898-9000.

Please inform all of the process to pay for this services and provide the proof of purchase and the add on the receipt.

Darid Candies  
704-612-1772

Adaline Comardelle  
504-952-0329



# PAYMENT RECEIPT

## payee information

Account No. 156816  
Customer Name Darid Candies

## payment detail

Payment/Receipt No. 38840.CC  
Payment Date 4/16/2026  
Payment Method Credit Card (Auth: 9h6k9kd8)  
Payment Entered By Josh Crowley  
  
Payment Amount 104.54

## campaign paid

Campaign/Order ID	Campaign Description	Paid Amount
184809	Natural and Scenic Rivers	104.54

## orders pre-paid

Order No.	Order Type	Paid Amount
#ID#	Payment	#PAID#



Campaign No. 184809  
 Today's Date 16 Apr 2026  
 P.O. Number Natural and Scenic Rivers  
 Sales Rep Mattinisha Singleton

bill-to

**Darid Candies**  
 715 N. Graham St unit 203  
 CHARLOTTE, NC 28202  
 Tel: 704 612-1772  
 Account No: 156816

advertiser

**Darid Candies**  
 715 N. Graham St unit 203  
 CHARLOTTE, NC 28202  
 Tel: 704 612-1772  
 Account No: 156816

campaign summary

Description Natural and Scenic Rivers  
 Start Date 4/20/2026  
 End Date 4/20/2026

cost summary

Campaign Amount \$104.54  
 Estimated Tax \$0.00  
 Pre-payment Amount \$#PREPAY\_AMOUNT#  
**Total \$104.54**

Pre-Payment Details

Pre-Payment Amount	Pre-Payment Date	Pre-Payment Card No.
--------------------	------------------	----------------------

No Pre-Payments on this order

advertisement

Line No.	Product	Description	Issue / Run Date	Size	Amount
603188	Baton Rouge Advocate Online	Legal Online Zero	4/20/2026	1	0.00

**PUBLIC NOTICE**

---

**Request for Scenic River Permit on Bayou Des Allemands**

The Secretary of the Louisiana Department of Wildlife and Fisheries (LDWF) as Administrator of the Louisiana Natural and Scenic Rivers System is currently considering

Line No.	Product	Description	Issue / Run Date	Size	Amount
603189	The Advocate Baton Rouge	Legal Open Rate	4/20/2026	1	104.54

is currently considering the application of Roy A. Comardelle Sr. to build a dock. Copies of the application can be reviewed at the LDWF main office, 2000 Quail Drive, Baton Rouge, LA. The public is invited to comment on this permit request for a period of forty-five (45) days. Responses should be mailed to LDWF Scenic Rivers Program, P.O. Box 98000, Baton Rouge, LA 70898-9000.

184809-APR 20-1T  
\$104.54

**PUBLIC NOTICE**

- - -

**Request for Scenic River Permit on Bayou Des Allemands**

The Secretary of the Louisiana Department of Wildlife and Fisheries (LDWF) as Administrator of the Louisiana Natural and Scenic Rivers System is currently considering the application of Roy A. Comardelle Sr. to build a dock. Copies of the application can be reviewed at the LDWF main office, 2000 Quail Drive, Baton Rouge, LA. The public is invited to comment on this permit request for a period of forty-five (45) days. Responses should

Line No.	Product	Description	Issue / Run Date	Size	Amount
		<p>days responses should  be mailed to LDWF  Scenic Rivers Program,  P.O. Box 98000, Baton  Rouge, LA 70898-9000.</p>	184809-APR 20-1T		\$104.54

**COPY OF ADVERTISEMENT**

## Candies, Darid

---

**From:** Thibodaux Legals <legals@dailycomet.com>  
**Sent:** Wednesday, April 15, 2026 7:22 PM  
**To:** Candies, Darid  
**Subject:** Thank you for placing your order with us.

---

This message is from an external sender (outside your organization)

### THANK YOU for your ad submission!

This is your confirmation that your order has been submitted to publish in the Public Notice/Classified section of the paper. Below are the details of your transaction. Please save this confirmation for your records.

We appreciate you using our online self-service ads portal, available 24/7. Please continue to visit Thibodaux Daily Comet's online Classifieds [HERE](#) to place your legal notices in the future.

**Deadlines vary by publication, changes and/or cancellations may not be honored due to deadline restrictions.**

### Notes

Dock Add Daily Comment

#### Job Details

Order Number:

**LLOU0501648**

Classification:

[Public Notices](#)

Package:

[General Package](#)

Additional Options:

1 Affidavit \$25.00

Total payment:

**\$93.88**

Payment Type:

[Chase](#)

#### Account Details

Shanon Candies

715 N Graham St Ste 203

Charlotte, NC □ 70030

504-952-0329

[Adaline.Comardelle@gmail.com](mailto:Adaline.Comardelle@gmail.com)

Credit Card - Chase XXXXXXXXXXXX3200

#### Schedule for ad number LLOU05016480

**Mon Apr 20, 2026**

**Thibodaux Daily Comet**

*All Zones*

**Tue Apr 21, 2026**

**Thibodaux Daily Comet**

*All Zones*

**Wed Apr 22, 2026**

**Thibodaux Daily Comet**

*All Zones*

Request for Scenic  
River Permit on  
Bayou Des Alle-  
mands

The Secretary of the Louisiana Department of Wildlife and Fisheries (LDWF) as Administrator of the Louisiana Natural and Scenic Rivers System is currently considering the application of Roy A. Comardelle Sr. to build a dock. Copies of the application can be reviewed at the LDWF main office, 2000 Quail Drive, Baton Rouge, LA. The public is invited to comment on this permit request for a period of forty-five (45) days. Responses should be mailed to LDWF Scenic Rivers Program, P.O. Box 98000, Baton Rouge, LA 70898-9000.  
April 20, 21, 22 2026  
LLOU0501648